

Net area	17675.84 SF
Total lines	115737 FT
Total counts	3 EA

CONTINUOUS FOOTING (WF) SCHEDULE 901-03

FOR CONSTRUCTION ABOVE FOOTING, SEE DETAILS. LONGITUDINAL REINFORCING. EQUAL SPACING U.N.O. TRANSVERSE REINFORCING

NOTE: 1. FOR DEPTH OF FOOTING, SEE G.S.N. U.N.O. 2. CENTER FOOTING ON CONSTRUCTION ABOVE U.N.O. 3. EXTEND FOOTINGS 12" BEYOND JAMBS U.N.O.

MARK	DIMENSIONS		FOOTING REINFORCING	REMARKS
	HEIGHT	WIDTH		
WF1	12"	3'-0"	4 - #5 CONTINUOUS AND #4 AT 12" O.C. TRANSVERSE	---

SEE S5.3 FOR FOUNDATION PLAN NOTES:

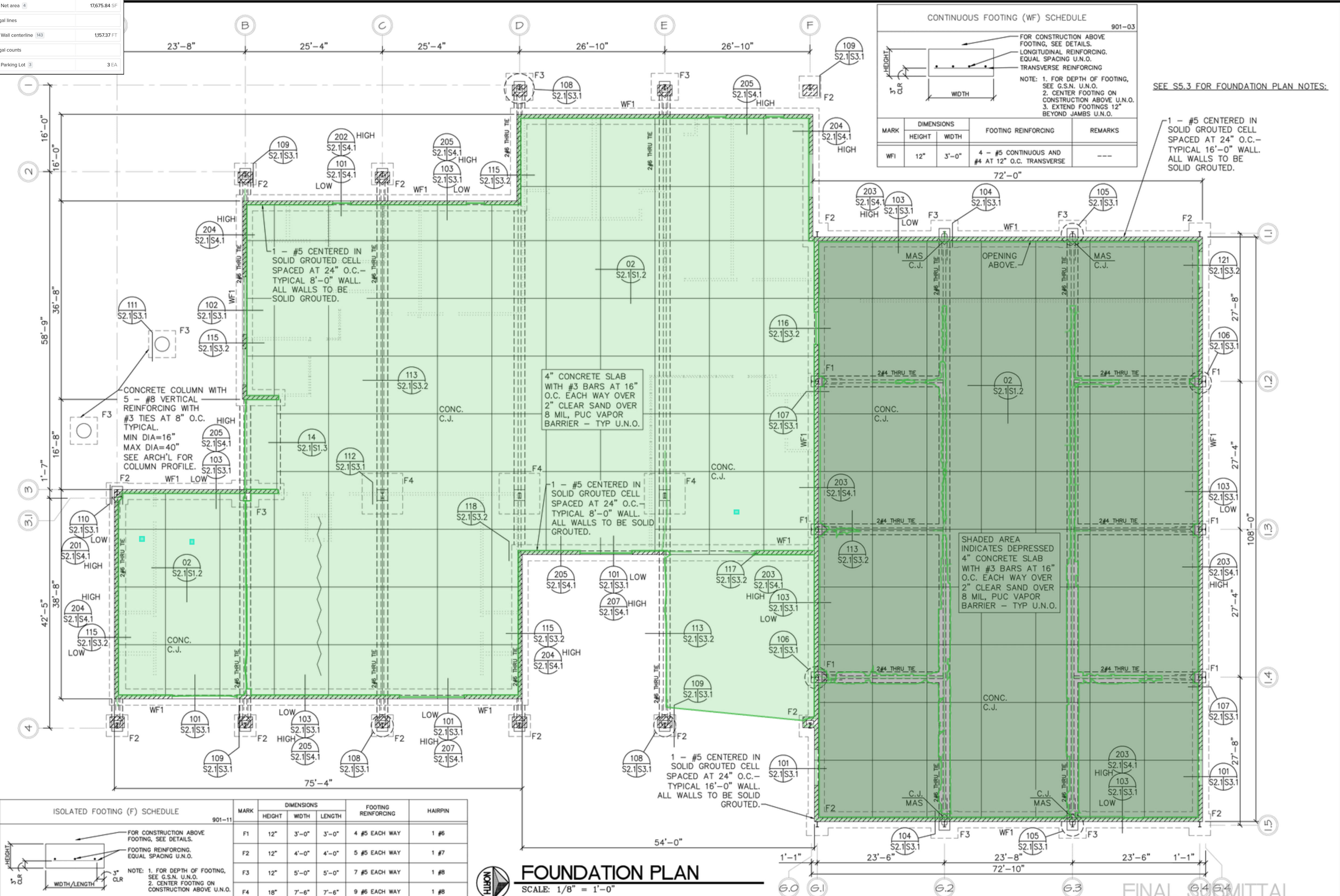

ISOLATED FOOTING (F) SCHEDULE 901-11

FOR CONSTRUCTION ABOVE FOOTING, SEE DETAILS. FOOTING REINFORCING. EQUAL SPACING U.N.O.

NOTE: 1. FOR DEPTH OF FOOTING, SEE G.S.N. U.N.O. 2. CENTER FOOTING ON CONSTRUCTION ABOVE U.N.O.

MARK	DIMENSIONS			FOOTING REINFORCING	HAIRPIN
	HEIGHT	WIDTH	LENGTH		
F1	12"	3'-0"	3'-0"	4 #5 EACH WAY	1 #6
F2	12"	4'-0"	4'-0"	5 #5 EACH WAY	1 #7
F3	12"	5'-0"	5'-0"	7 #5 EACH WAY	1 #8
F4	18"	7'-6"	7'-6"	9 #6 EACH WAY	1 #8

FOUNDATION PLAN
SCALE: 1/8" = 1'-0"

REVISIONS		DATE	DATE	DATE	DATE
SYMBOL	DESCRIPTION	APPROVED	PREP. BY	SUBMITTED	DESIGN

SAISFACTORY TO:	DATE	DATE	DATE	DATE
FAC MNG. OFFICER:				
DIRECTOR OF ENG.:				
SW DIV FOR COMMANDER NAVFAC:				

DEPARTMENT OF THE NAVY	NAVAL FACILITIES ENGINEERING COMMAND	CALIFORNIA
SAN DIEGO	SOUTHWEST DIVISION NAVAL FACILITIES	
	P-491 YOUTH CENTER	
	MARINE CORPS AIR STATION	
	YUMA, ARIZONA	
	FOUNDATION PLAN	

SIZE D
IF SHEET IS LESS THAN 22" X 34" IT IS A REDUCED PRINT - SCALE REDUCED ACCORDINGLY

PWO. NO. _____

PROJECT LOCATION
YUMA, ARIZONA

CONSTR. CONTRACT NO.
N68711-02-C-2018

SPEC.
NAVFAC DRAWING NO.
8175782

SHEET 49 OF _____

S2.1

FINAL SUBMITTAL